

RoHS

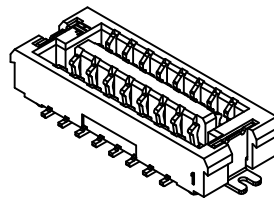
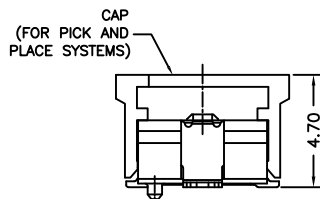

SPECIFICATIONS

Current Rating: 1A AC,DC
 Voltage Rating: 50V AC,DC
 Temperature Range: -25°C ~ +85°C
 Contact Resistance: 20mΩ Max.
 Insulation Resistance: 100MΩ Min.
 Withstanding Voltage: 500V AC/minute
 Material:

Wafer: LCP UL94V-0
 PIN: Phosphor Bronze,G/F
 Solder: Phosphor Bronze,T-P
 Cap: LCP UL94V-0,Black

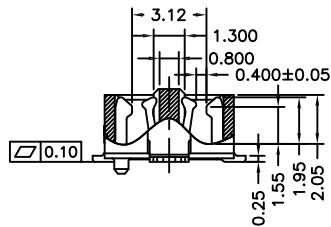
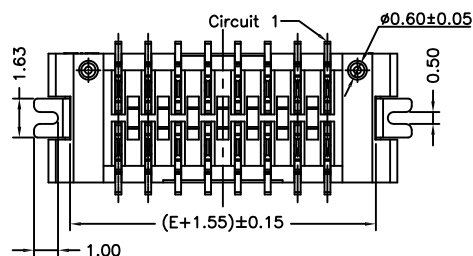
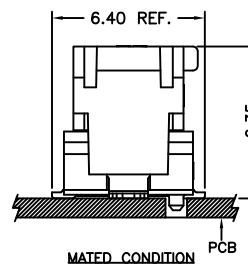
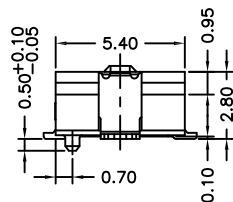
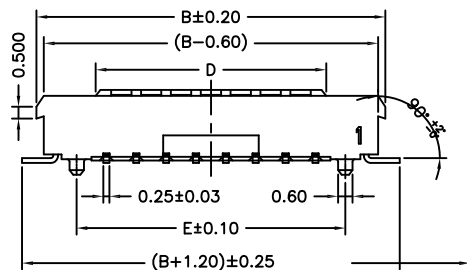
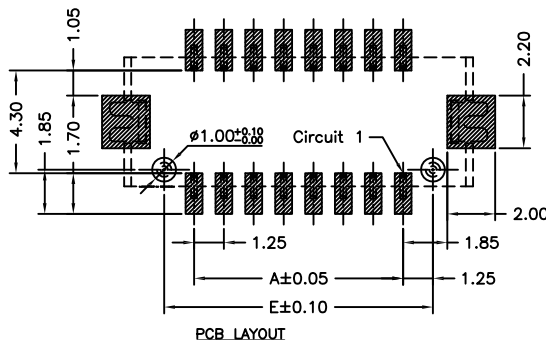
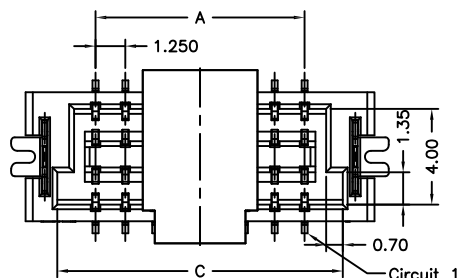

Circuits	Dimensions				
	A	B	C	D	E
2X5	5.00	10.85	8.20	5.90	7.50
2X7	7.50	13.35	10.70	8.40	10.00
2X8	8.75	14.60	11.95	9.65	11.25
2X10	11.25	17.10	14.45	12.15	13.75
2X15	17.50	23.35	20.70	18.40	20.00
2X18	21.25	27.10	24.45	22.15	23.75
2X20	23.75	29.60	26.95	24.65	26.25
2X21	25.00	30.85	28.20	25.90	27.50
2X25	30.00	35.85	33.20	30.90	32.50
2X30	36.25	42.10	39.45	37.15	38.75

REVISION RECORD

REV.	DATE	DESCRIPTION	CHANGE	APPROVE

TOLERANCE

.0±0.25
 0.00±0.15
 0.000±0.05

DRAW

DESIGN
 CHECK
 APPROVE
 VERSION

地信

地信

吳奇春

吳奇春

XP1

SCALE

1:1
 UNIT
 SIZE
 SHEET
 PROJ.

mm
 A4
 1/1



耀聯電子科技有限公司
 UNC Electronic & Technology Co., Ltd

PART NO.

A1259WV0-S-NP-KA

DESCRIPTION

1.25 Pitch 180° Dual-row Wafer (SMT)

DRAWING NO.

A1259.dwg

TEL:0769-87299998 FAX:0769-87299968 E-Mail:uniconn@163.com WEB:http://www.uniconn.cn